

# CLASSIC BEAUTY

*Shifting the entrance and adding spa-like design touches revitalize a 1930s master bath in Dallas.*

WRITER Becky Mollenkamp PHOTOGRAPHER Nathan Schroder FIELD EDITOR Donna Talley



## STYLE

Refreshed Traditional

## PROBLEM

A 1980s master bath remodel was out of character in the 1930s Tudor-style home purchased by Wes and Ashley Martin. In addition to its dated design, the bath lacked windows, making it feel dreary, and it featured an odd bank of shallow cabinets that provided little usable storage.

## SOLUTION

Construction consultant Carol Gantt moved the bathroom door from the hallway to the master bedroom, but the room's footprint otherwise remained largely unchanged. She added an arch similar to others found in the home, reshaped the vaulted ceiling, and added a large window over the bathtub to flood the room with light. Interior designer Emily Larkin filled the remodeled space with finishes reminiscent of the home's era. "It's traditional but up-to-date," Larkin says. "It will stand the test of time."

FOR RESOURCES, SEE PAGE 92.

## STORE MORE

Relocating the bathroom door, *opposite*, in the master bedroom allowed construction consultant Carol Gantt to create a grand entrance with a period-appropriate archway and linen closets in the vestibule. She also added a built-in bank of storage next to the tub. These changes make the new bathroom a storage powerhouse.

## VINTAGE STYLE

A freestanding tub, *opposite*, took the place of a platform tub with an unsafe tiled step. The tub and the polished-nickel faucet with handheld shower, *left*, are new but have a classic look appropriate to the era of the home.

## KEY FEATURES

- 1 Entry point** Moving the door from the long wall to the short wall makes the space feel larger and less cluttered.
- 2 Architectural elements** An arch similar to others in the house connects the renovated bathroom to the original period of the home.
- 3 Natural light** A large window over the bathtub pulls much-needed light into the room.
- 4 Better storage** Replacing a wall of bulky cabinets with linen closets in the entryway and a built-in storage chest improves the room's function and appearance.
- 5 Classic touches** Updating the tired 1980s cabinetry, fixtures, and surfaces with timeless designs allows the space to flow with the rest of the home.



BEFORE



**BEFORE**

## DISTINCTIVE VANITY IDEAS

Bath vanities set the tone for style and storage. Here are a few of our favorites.



### WATERFALL EFFECT

Continue the countertop material to the floor for a dramatic look that wraps the vanity in modern style.



### OFFSET THE SINK

There's no rule that a sink must be in the center of the vanity. Gain more usable counter space by opting for an off-center sink.



### MAKEUP STATION

Add comfort to the morning routine with a section of lowered counter for sitting while styling hair or applying makeup. Include drawers for small products.



### VISUAL VARIETY

The harsh, oversize mirror of the old room was replaced by a trio of shapely mirrors over each sink and the makeup vanity, *opposite*. The curves are echoed in the vanity stool below. "It's nice to add some shapes for interest, rather than having everything be so squared off," interior designer Emily Larkin says. She believes variety is the spice of life, which is why she mixed marble tile shapes and patterns throughout the bath.

### ENLIGHTENED MOOD

The once-dark and dated bathroom is now bright and cheery thanks to a new large window, *above*, on the back wall. It lets in sunlight and also provides a treetop view from the room's focal point freestanding tub. The walls and ceiling are painted seafoam green to add to the serene, soothing atmosphere.

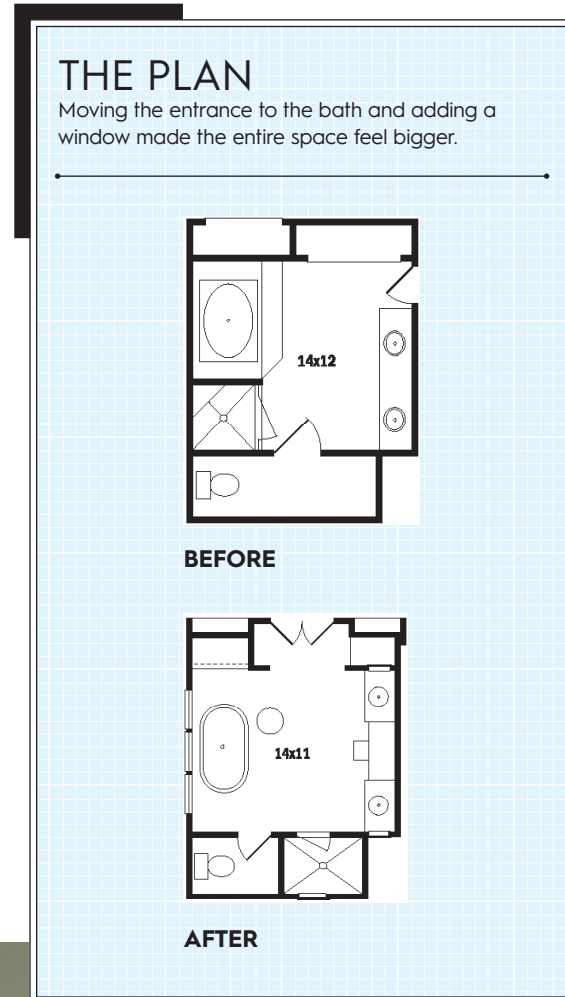

“DESIGN TRENDS  
WILL CHANGE, BUT A  
FUNCTIONAL LAYOUT WILL  
ALWAYS LOOK GOOD.”

— CAROL GANTT,  
CONSTRUCTION CONSULTANT

#### DELICATE DETAIL

A chandelier, *above*, “is the jewelry of a room,” Larkin says, and this gold-and-pearl piece adds a feminine touch to the shared bathroom.

#### A LITTLE SPARKLE

To avoid the monotony of matching metal pulls on every drawer and cabinet, Larkin opted to use crystal knobs instead, *right*. “The clear look is very classy and clean,” she says.

#### PRETTY & PRACTICAL

Roman shades, *opposite top*, in a graphic ikat print soften the look of the bathroom and provide privacy.

#### CHARMING CHOICES

Although new, the sink faucets, *opposite bottom left*, have soft curves and cross handles for a gracefully nostalgic look. The vanity countertop, *opposite bottom right*, is Calacatta marble, which has dramatic veining and warm tones that add distinction to the space.

